

# KV-1060

CODE	項目	Unit	KV-1060
Travel range (X / Y / Z)	行程範圍(X/Y/Z)	mm	1060 / 600 / 600
Table size (L×W)	工作台尺寸	mm	1200×600
Max. table load (Roller linear guide way)	工作台負荷 (滾柱線軌)	kg	1200
Distance from spindle nose to table top	主軸鼻端到工作台距離	mm	150~750
T-slot size	T型槽尺寸	mm	5 × 18×100
Spindle taper type	主軸刀把型式		BT40 ( BT50 )
Max. spindle speed	主軸轉速	rpm	直結 15000 ( 8000 )
Spindle power ( rated / max )	主軸馬達輸出功率(額定/最大)	KW	8.5 / 33 ( 15 / 38 )
Spindle torque ( rated / max )	主軸馬達輸出扭力(額定/最大)	Nm	20 / 80 ( 96 / 240 )
Rapid traverse rate ( X / Y / Z )	快移速度(X/Y/Z)	m/min	48 / 48 / 48
Distance Guide way span ( X / Y / Z )	線軌跨距 ( X / Y / Z )	mm	655 / 650 / 365
Number of pocket	刀具數量	pcs	24 ( 32 )
Max. tool diameter	最大刀徑	mm	75 ( 125 )
Max. tool diameter (adjacent station empty)	最大刀具直徑(相鄰空刀)	mm	150 ( 250 )
Max. tool length (from spindle nose)	最大刀具長度	mm	300
Max. tool weight	最大刀具重量	kg	7 ( 18 )
Air pressure required	空壓需求	kg/cm <sup>2</sup>	6
Machine weight	機械重量	kg	10500 ( 11000 )
Machine dimensions (LxWxH)	機械外觀尺寸(長×寬×高)	mm	3600×2300×3330

- The data shown in parenthesis are for BT50 Spindle option.
- As the manufacturer constantly improves the machine specifications and design characteristics, above specifications are subject to change without notice.
- 規格表內括弧內容為選配BT50主軸規格。
- 本公司對產品規格、設計特性均不斷研究改進，上述規格若有變更，恕不另行通知。

**KOVA** 協銳精密工業股份有限公司  
**KOVA PRECISION INDUSTRIAL CO., LTD.**

台灣 41278 台中市大里區仁化工十二路 27 號  
 No.27, Renhuagong 12th Rd, Dali Dist., Taichung City 41278, Taiwan.  
 TEL: 886-4-2496 6000 FAX: 886-4-2496 8000  
 E-mail: info@kova.com.tw



# KV-1060

Gantry Type Machining Center  
 門型加工中心機

**KOVA**  
 info@kova.com.tw

# KV-1060 Gantry Type Machining Center 門型加工中心機

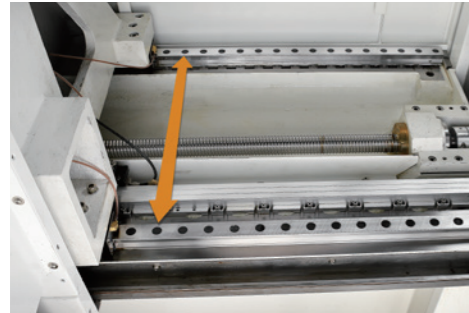

Large diameter ball lead screw and wide span Roller Guide way ensure high load capacity, low friction, and low vibration movement.

大直徑滾珠螺桿及寬跨距滾柱導軌確保高承載重量，低摩擦及低震動之運動。

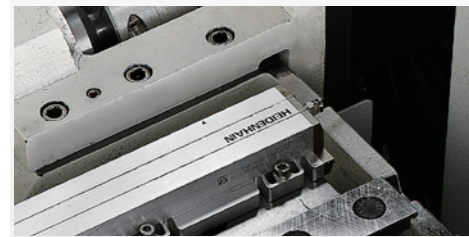

All three linear axes are equipped with high accuracy, high resolution, absolute linear scales as standard, guarantee the machine accuracy and quality.

三個線性軸標準配備高精度、高解析度、絕對式光學尺，確保機器加工之精度及品質。

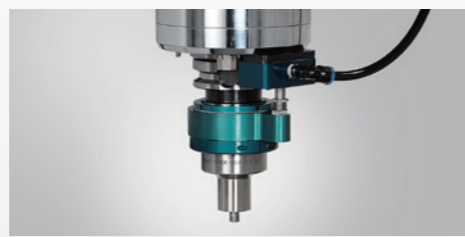

With optional 40000 rpm High speed and high torque air turbine spindle make it possible to execute high speed cutting with small diameter tools. (Option)

搭配選配40000轉高轉速高扭力氣動渦輪主軸，可進行小刀徑高速切削。(選配)

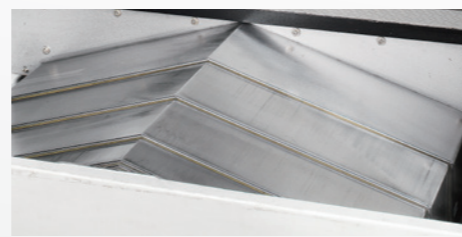

High step Y axis protection cover makes chip removing more efficiently.

高陡度Y軸防護罩，使得切屑排除更加有效率。

## TABLE 工作台

Unit: mm

## BT-40

Unit: mm

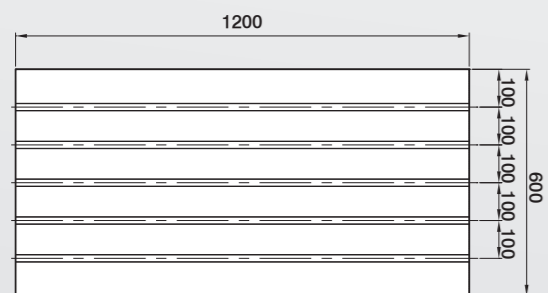

## T-slot T型槽

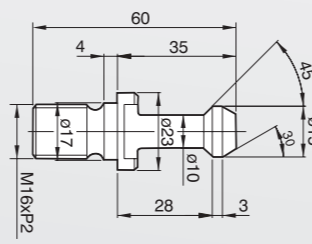
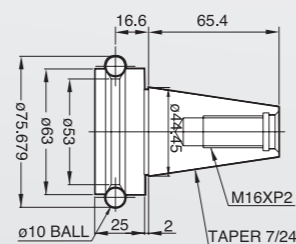
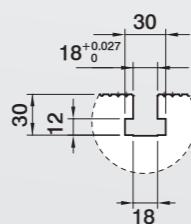

## DIMENSIONAL DRAWING 外觀尺寸圖

Unit: mm

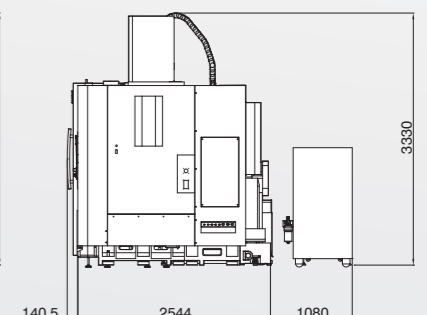
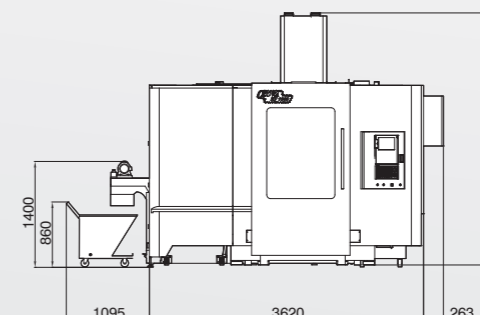
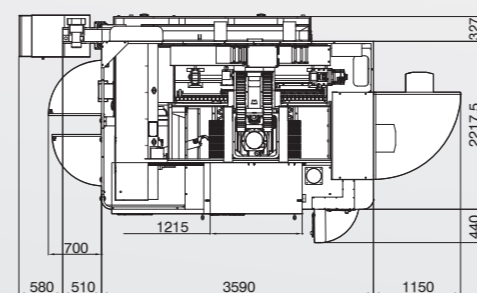

## Milling Spindle

Different type of direct-drive and built-in spindles are available for various machining requirement.

## 主軸系統

多種不同型式之直結及內藏式主軸可供選擇，以適應不同之加工需求。

## Rigid Construction

All major structural parts are manufactured from Meehanite cast iron with maximum material stability annealed and vibratory stress relieved. Finite Element Analysis is also conducted to optimise the machine structure and structural parts ratio. This results in more stable support and superior force distribution during cutting.

## 高剛性結構

整機採用米漢納鑄鐵鑄造，材料穩定，並經退火與振動內應力消除，並採用有限元素分析達到最佳化的強健結構與比例，使加工時擁有最穩定的支撐與完美的力流線。

## High Efficiency Feed System

Three axes are mounted with high precision roller type linear ways, providing high feed rates up to 48 m/min. In addition, the best machining accuracy and reduced moving time can be achieved.

## 高效率進給系統

三軸向採用高精度滾柱線軌，提供48 m/min的高進給與高速度，保證最佳加工精度與最少的位移時間。

## Central Lubrication System

Central lubrication system employs a proportional oil distributor to ensure oil is properly delivered to each drive periodically.

## 中央潤滑系統

採用比例式潤滑油分配器，確保定期供應各單元的需求油量。

## Chip Removing System

Two tunnels formed between machine base and table, combined with two chip augers and steep Y axis cover makes chip removing more efficiently to the back of machine.

## 排屑系統

底座與工作台間形成兩個排屑隧道，搭配兩組捲屑機及高陡度之Y軸防護罩，使得切屑能更有效的被排至機器後方。