

CODE	項目	Unit	KF-300
X,Y,Z-axis travel range	行程範圍(X/Y/Z)	mm	300/400/270
X,Y,Z-axis rapid traverse rate	快移速度(X/Y/Z)	m/min	48/48/48
Table size	工作台尺寸	mm	1600x450
Max. table load	工作台最大負荷	kg	200
Distance from spindle nose to table	主軸鼻端到工作台距離	mm	立柱標準高:80~350
			立柱加高100:180~450
			APC:80~350
T-slot size	T形槽尺寸	mm	14
Number of spindle	主軸數目	pcs	4
Spindle taper	主軸刀把型式		HSK-E40
Max. spindle speed	主軸轉速	rpm	30000
Spindle motor power output(rated)	主軸馬達額定輸出功率	KW	4.6
Spindle motor power output(max.)	主軸馬達最大輸出功率	KW	5.3
Spindle motor torque output(rated)	主軸馬達額定輸出扭力	Nm	4.4
Spindle motor torque output(max.)	主軸馬達最大輸出扭力	Nm	5.1
Magazine type	刀庫型式		平置式刀庫 Horizontal magazine
Magazine pocket number	刀具數量	pcs	32 (選購opt.:48)
Max. tool diameter(adj. tool)	最大刀具直徑(相鄰刀)	mm	50
Max. tool length(form spindle nose)	最大刀具長度	mm	165
Max. tool weight	最大刀具重量	kg	4
Air pressure required	空壓需求	kg/cm ²	6
Machine weight	機械重量	kg	9500
Machine dimensions(LxWxH)	機械外觀尺寸	mm	立柱標準高:3300x2300x2600
			立柱加高100:3300x2300x2850
			APC:3300x5100x2850

- AS the manufacturer constantly improves the machine specifications and design characteristics, above specifications are subject to change without notice.
- 本公司對產品規格、設計特性均不斷研究改進，上述規格若有變更，恕不另行通知。

Standard Equipment	標準配備	Optional Equipment	選購配備
Spindle oil cooler	主軸油冷單元	HSK E40, 48 tools horizontal	HSK E40 平置式刀庫 48 把刀
Spindle air barrier	主軸鼻端氣幕防屑裝置	Coolant through spindle (CTS)	主軸中心出水(CTS)
Spindle air blast	主軸換刀吹氣裝置	Oil mist cooling device	油霧冷卻裝置
HSK E40 30,000 rpm built-in type spindle	HSK E40 30000rpm 內藏式高速主軸	Automatic Pallet Changer(APC)	交換工作台(APC)
HSK E40, 32 tools horizontal magazine	HSK E40 平置式刀庫 32把刀	Chain type chip conveyor	履帶式鐵屑輸送機
Coolant system	主軸切削冷卻系統	Chip cart	集屑車
Chip bin	集水箱	Twin augers chip conveyor	雙螺旋式排屑裝置
Chip filter tank	集屑過濾箱	Oil coolant separator	油水分離機
Machine cabin side flushing	外罩側沖水裝置	Workpiece measuring system	機內工件測量系統
Heat exchanger for electrical cabinet	電氣箱熱交換器	Tool measuring system	機內刀具測量系統
MPG handwheel	MPG 手輪	X, Y, Z-axis linear scale	X.Y.Z.軸光學尺
Three-color indication lamp (red, yellow, green)	三色指示燈(紅,黃,綠)	High accuracy air filtering device	高精度空壓過濾裝置
Work light	工作燈	Air conditioner for electrical cabinet	電氣箱空調冷氣
Automatic lubrication system	自動潤滑系統	Transformer	變壓器
Fully enclosed splash guard	全閉式防屑鍍金護罩	Voltage stabilizer	穩壓器
Pneumatic system	空壓系統	Coolant gun	水槍
Leveling bolts and blocks	水平調整螺絲與墊片	Oil mist collector	油霧回收裝置
Operation manual	操作說明書		

KOVA

協銳精密工業股份有限公司
KOVA PRECISION INDUSTRIAL CO., LTD.

台灣 41278 台中市大里區仁化工十二路 27 號
No.27, Renhuagong 12th Rd, Dali Dist., Taichung City 41278, Taiwan.
TEL: 886-4-2496 6000 FAX: 886-4-2496 8000
E-mail: info@kova.com.tw http://www.kova.com.tw



KF-300

Vertical Multi-Spindle High Speed Machining Center
立式多主軸高速加工機

KF-300

Vertical Multi-Spindle High Speed Machining Center 立式多主軸高速加工機



Automatic Pallet Changer (APC)

To meet mass production and high efficiency machining requirements, the automatic pallet changer (APC) is recommended. It not only dramatically reduces non-cutting time in workpiece setup but also provides a best solution for workpieces requiring long clamping time.

交換工作台

因應批量生產與高效率的加工需求，提供您搭配自動交換工作台 (APC) 的生產解決方案，可減少工件設定的非切削時間和工件夾持時間較長需求的最佳選擇。

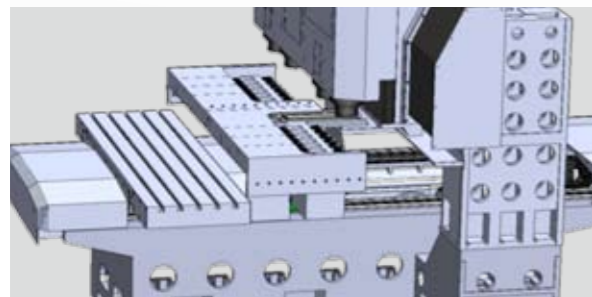

Patented Direct-drive Magazine

The innovative direct-drive magazine combined with 48 M/min rapid traverse rate on three axes make it easy and quick to change tools simultaneously for all spindles.

專利設計直結式刀庫

全新開發的直結式刀庫，搭配三軸的 48 m/min 高速進給，完成多主軸系統，簡單快速流暢的同步換刀動作。

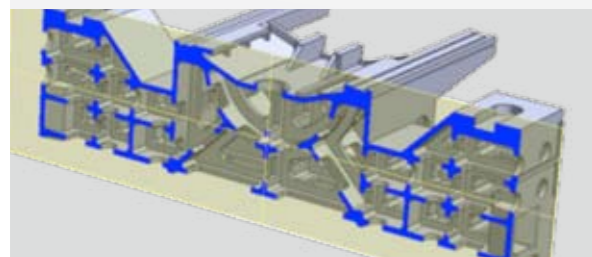

Rigid Construction

Reinforced double column construction in combination with rigid base enable the KF-300 to fully exhibit its extra-high machining stability.

高剛性結構

強化型的龍門結構，及高剛性的底座設計，造就 KF-300 優越的加工穩定性。



High Speed Carving

Applicable for machining 3C parts, automotive and motorcycle parts, bicycle parts as well as medium and small size measuring parts, etc.

高速雕銑加工

3C機構件、汽機車零件、腳踏車零件、以及中小尺寸量件...等加工。

High Speed Panel Machining

Applicable for machining ceramic, cell phone panel, DVD panel, touch-screen, solar energy panel and thin lense panel, etc.

高速面板加工

陶瓷、手機面板、DVD面板、觸控面板、太陽能板、LENS 薄板...等加工。

High Speed Glass Grinding

Applicable for machining camera lens, circular cutting, wafer cutting, chip cutting, glass panel, NB protective board cutting, LCD and LED light guide board and back light board, etc.

高速玻璃研磨加工

相機鏡片、圓形切割、晶圓切割、晶片切割、玻璃面板、NB保護板切割、LCD及LED導光板、背光板...等加工。



The KF-300 is multi-spindle (4 spindles) simultaneously controlled high speed machining center. It creates 4 times of productivity comparing to a single spindle machining center, resulting in shortened delivery time and increased competition capability. Besides, the KF-300 also provides a great reduction of factory utilization cost by 60% compared with 4 machines.

KF-300為多主軸(4支主軸)同動加工的高速加工機，在相同加工的時間，可以為客戶帶來四倍於單主軸加工機的產能，讓客戶大量生產的產品能縮短交期，更具競爭力。

KF-300佔地面積相對採用四部機台，其廠房建製成本降低60%。

TABLE 工作台 Unit: mm

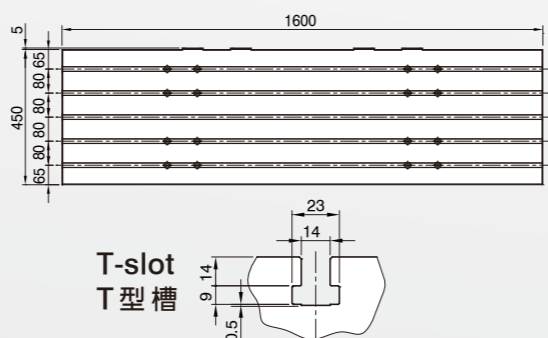

HSK-E40 Unit: mm

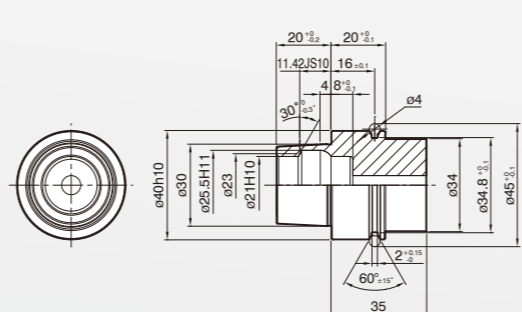

DIMENSIONAL DRAWING 外觀尺寸圖 Unit: mm

